

FASE 2

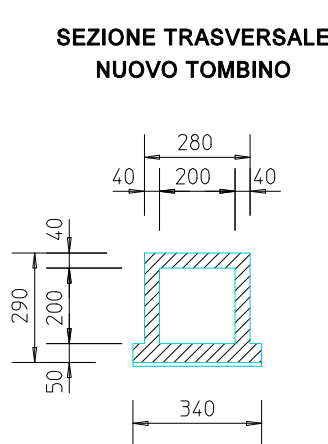

Sez. 334 bis
Q.Rif. : 235.00

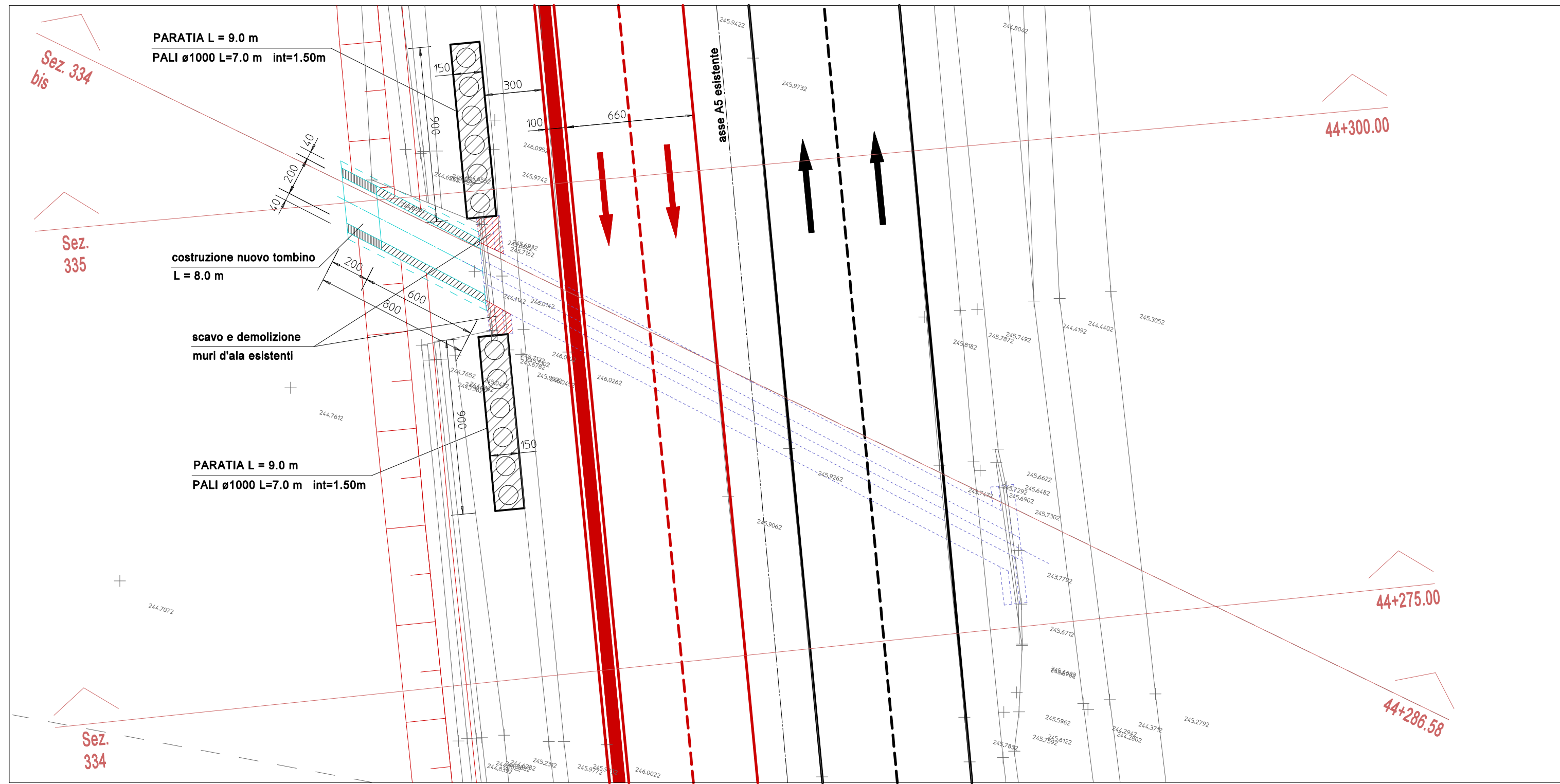
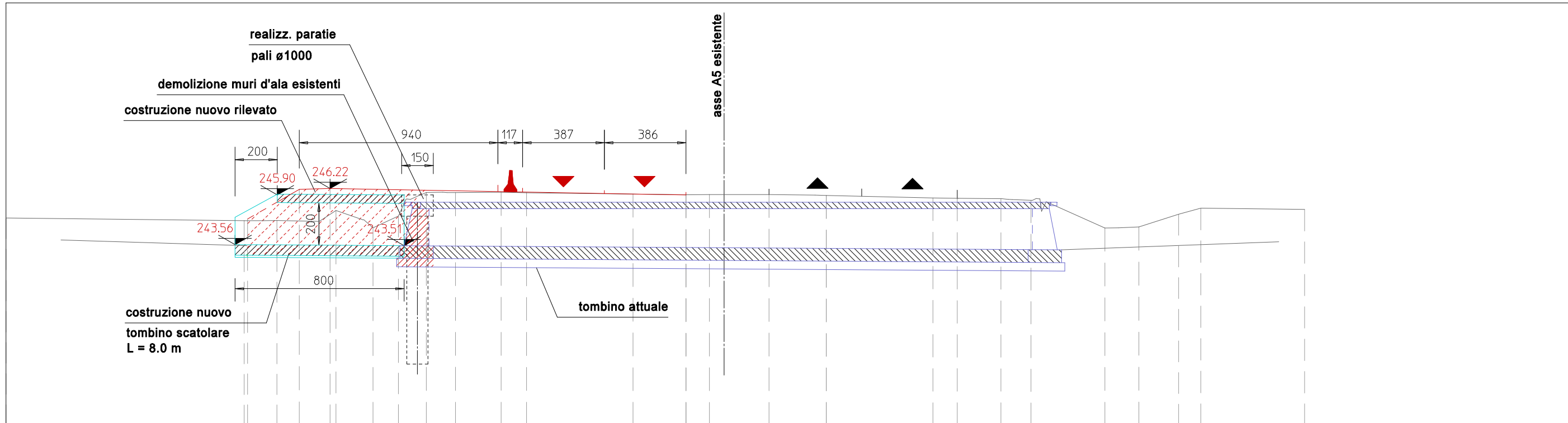

FASE 4

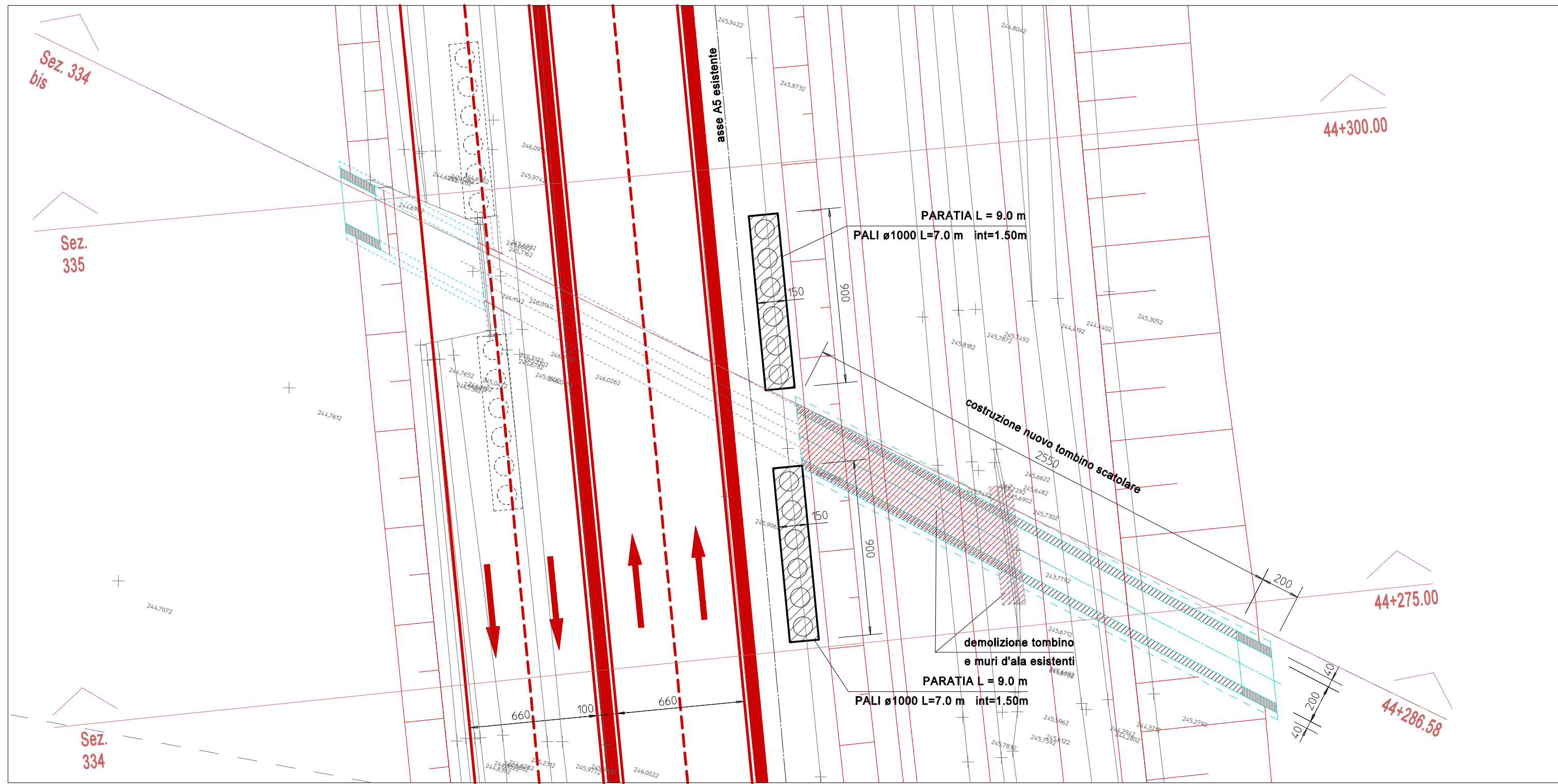

Sez. 334 bis
Q.Rif. : 235.00

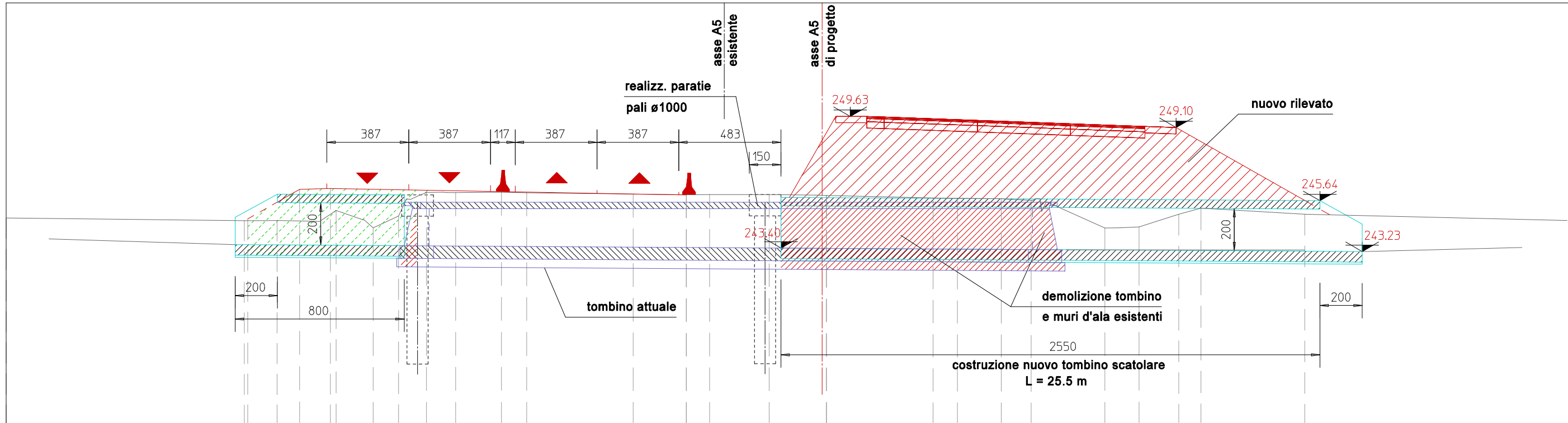

SEZIONE TIPO TOMBINO ESISTENTE

SCALA 1 : 100

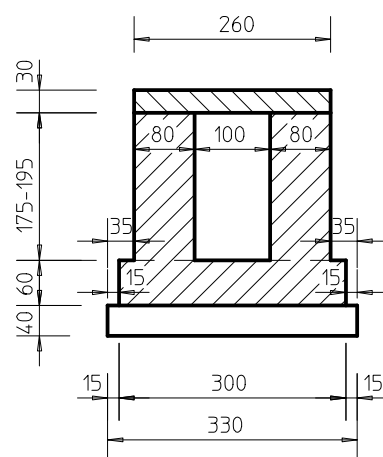

SEZIONE TRASVERSALE
NUOVO SCATOLARE

SCALA 1 : 100

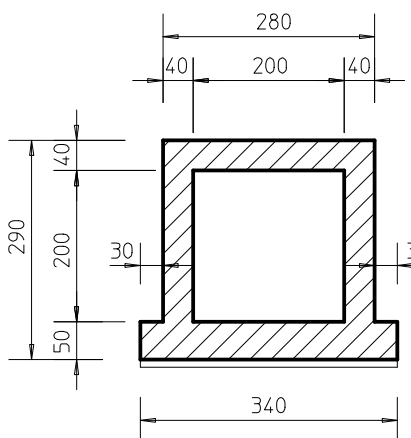

SEZIONE TRASVERSALE
IMBocchi LATERALI

SCALA 1 : 100

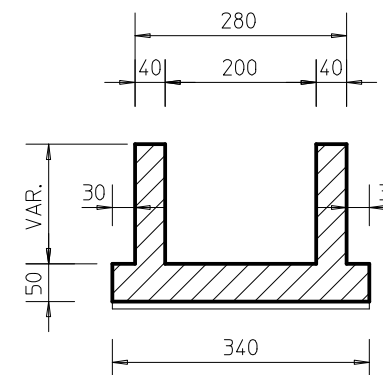

FASE 5

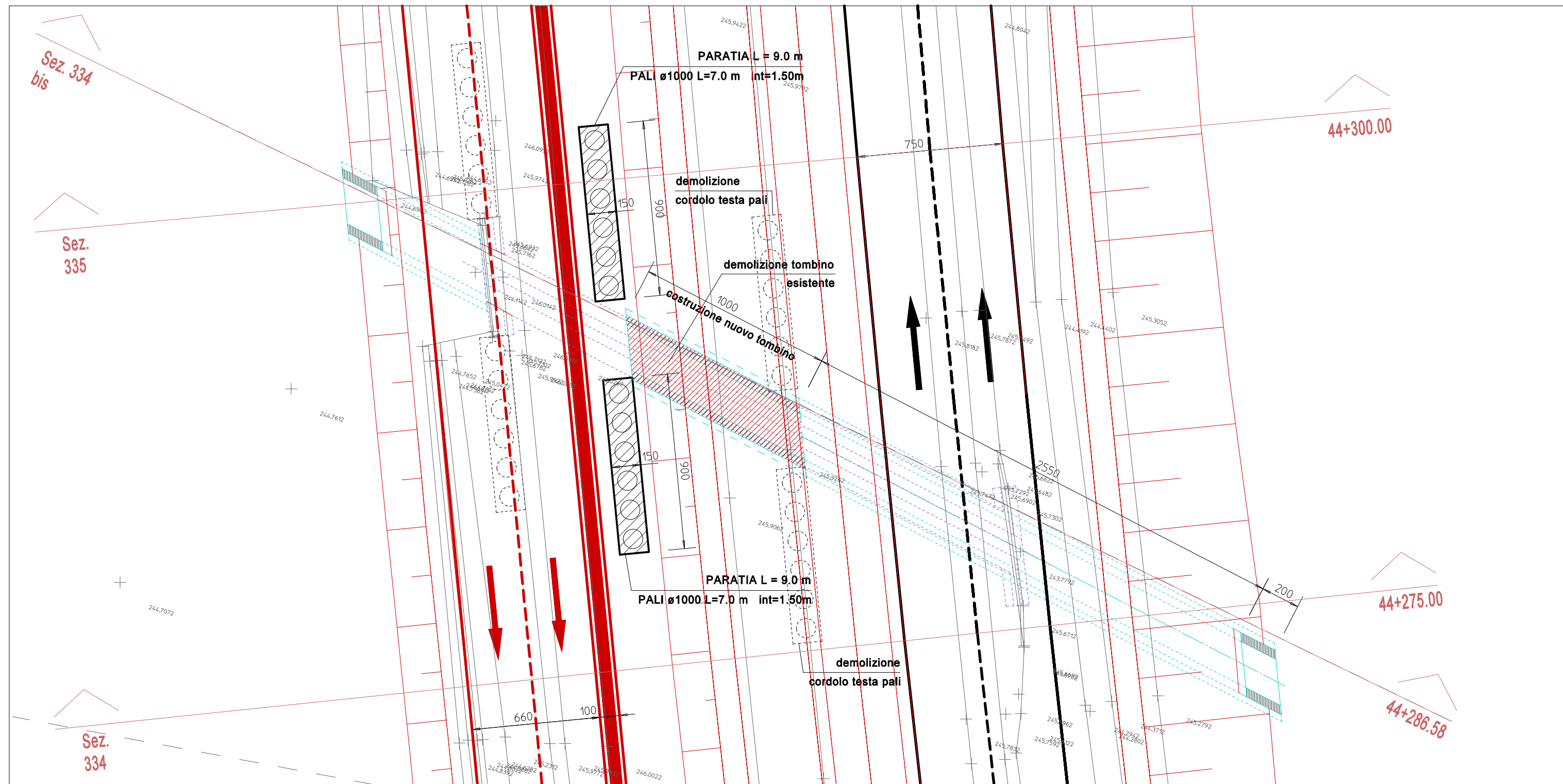

Sez. 334 bis
Q.Rif. : 235.00

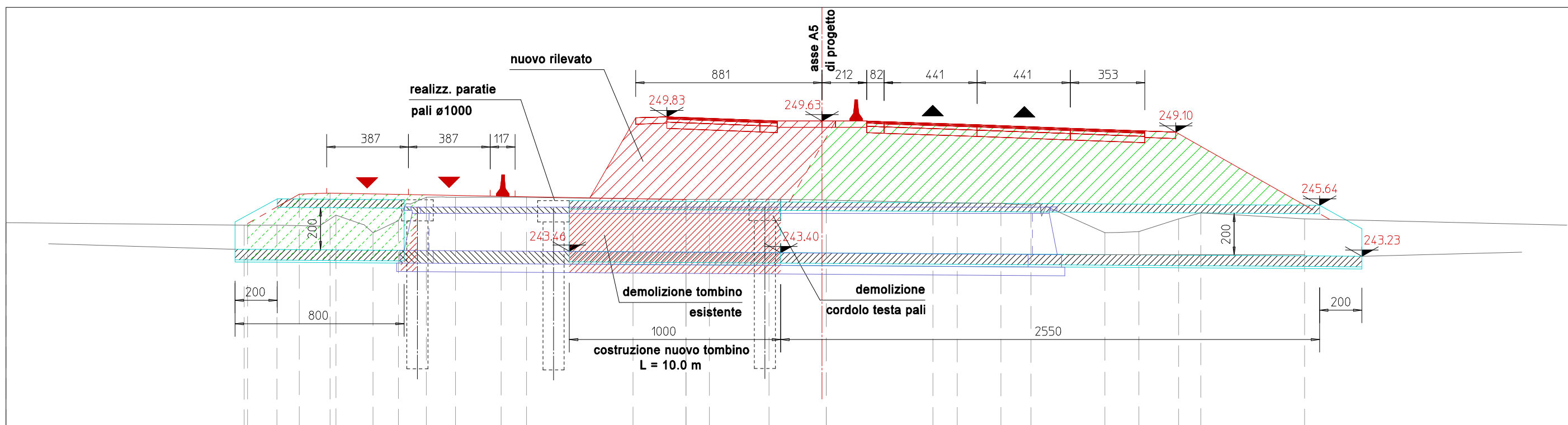

FASE 6

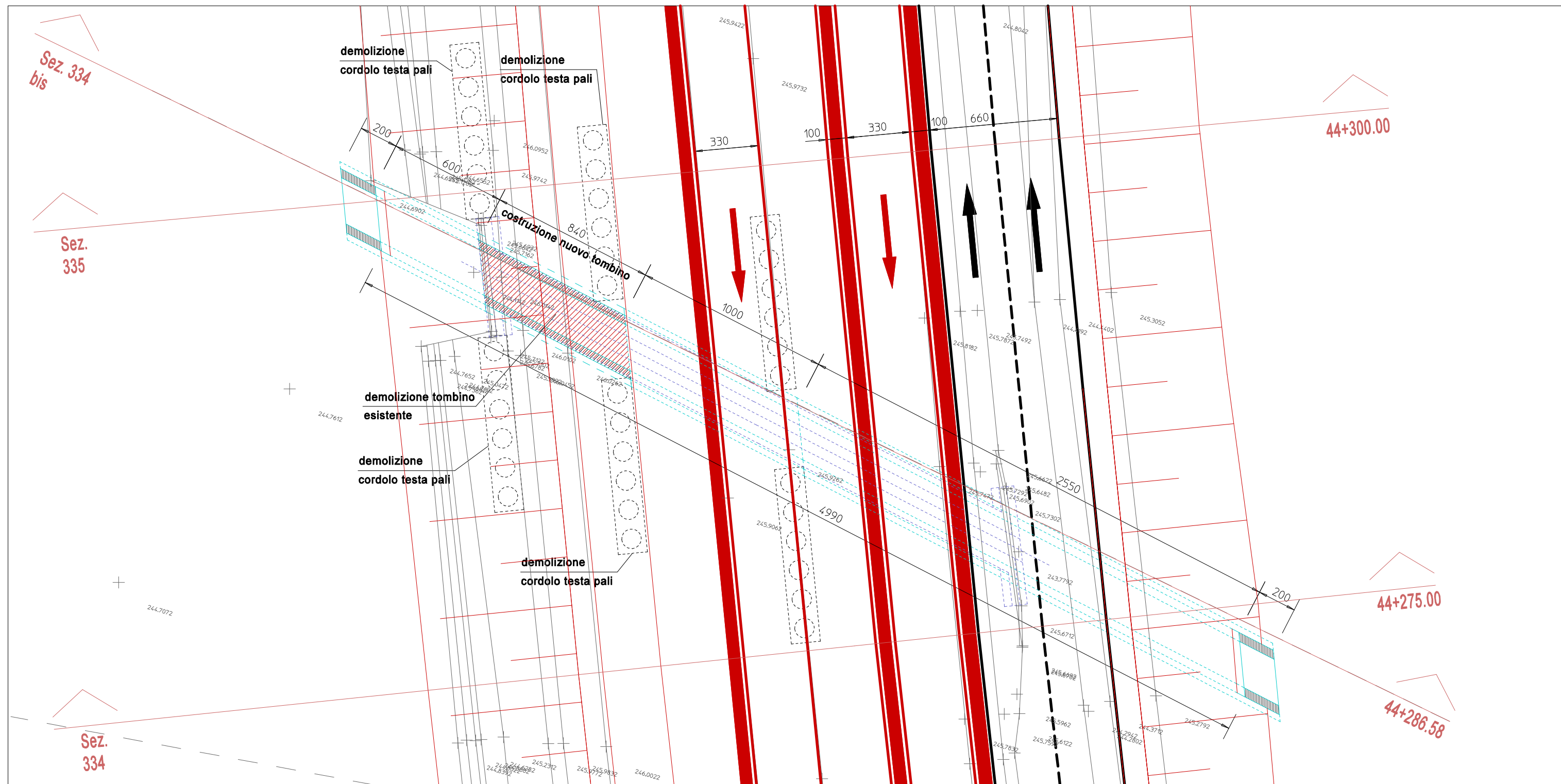

Sez. 334 bis
Q.Rif. : 235.00

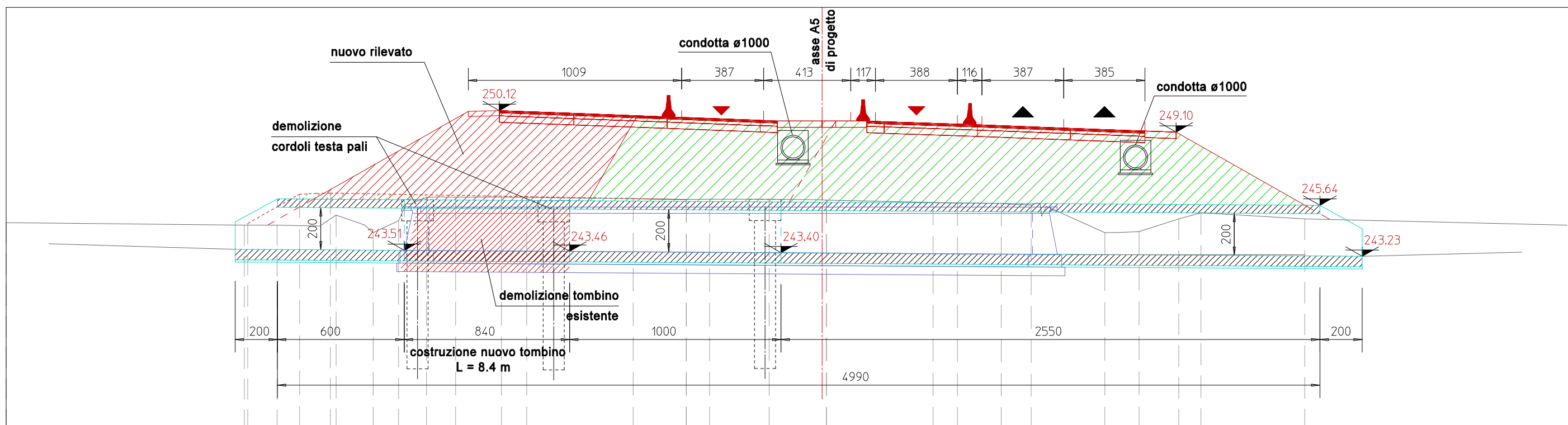

TORINO - IVREA - QUINCINETTO
IVREA - SANTHIA'
SISTEMA AUTOSTRADALE
TANGENZIALE DI TORINO

VISTO per FATNA S.p.A.



Amministratore Delegato
Dott. Ing. LUIGI CRESTA

AUTOSTRADA A4/A5 - A5 TORINO QUINCINETTO
IVREA SANTHIA'

NODO IDRAULICO DI IVREA
2° FASE DI COMPLETAMENTO

PROGETTO DEFINITIVO

PARTE STRUTTURALE - OPERE MINORI
TOMBINO SCATOLARE AL km 44+287
DISEGNO D'INSIEME

IL PROGETTISTA	REDATTO	CONTROLLATO	APPROVATO
IGEAS	IGEAS	IGEAS	ATIVA ENGINEERING
P. Einaudi	P. Einaudi	M. Barale	V. Palmisano
DATA	DATA	REVISIONE	DATA
GIUGNO 2012	GIUGNO 2012		
SCALA	SCALA		
1 : 200	1 : 200		
UFFICIO	COMMISSIONE	N° PROG.	FASE
SSP0101A05000PDSTR50200			